

mDD Explosion-proof LED signal beacon

- Certified for gas and dust hazardous areas of zone 1, 2, 21, 22
- Encapsulation "m"
- Polycarbonate plastic housing
- mounting bracket V4A

- 5 LED colours
- Degree of protection IP 66
- Protection class II (AC) or III (DC)
- Terminal connection chamber "increased safety e"

II 2 G Ex e mb (ib) IIC T4

II 2 D Ex mbD tD A21 IP 66 T130 °C

-40 °C ≤ Ta ≤ +60 °C (AC-Mod.)

-40 °C ≤ Ta ≤ +65 °C (DC-Mod.)

Zone 1, 2, 21, 22



TECHNICAL DATA

| | |
|-----------------------|--|
| Housing | Ø 103 mm, Polycarbonate black (RAL 9005) |
| Lens | Polycarbonate, clear |
| Type of mounting | Bracket for wall mounting, V4A, any |
| Cable entry | Cable gland M20 × 1.5, 2× blind plugs M20 × 1.5 |
| Connection technology | bis 2,5 mm ² |
| Beacon type | LED steady beacon, LED flashing beacon, LED strobe beacon or LED all-round light |
| Light source | LEDs |
| Luminous intensity | 14 Cd (rot) |
| Duty cycle | 100 % |
| Operating temperature | -40 °C / +60 °C |
| Degree of protection | IP66 |
| Weight | 2,5 kg |

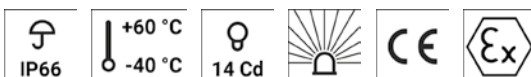
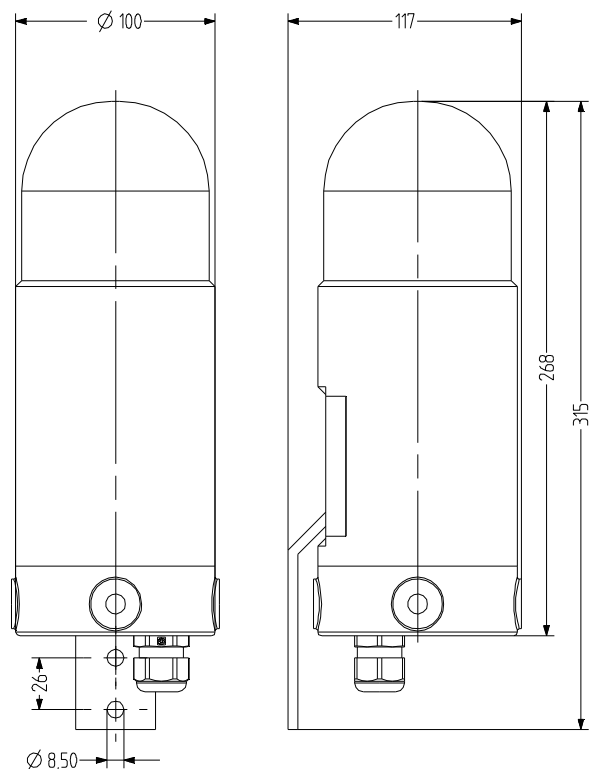

mDD

ORDER DATA

| Type | Lens colour | Colour | Nominal voltage | Voltage range (V) | Nominal current (A) | Order number |
|------|-------------|--------|-----------------|-------------------|---------------------|--------------|
| mDD1 | clear | red | 230 V AC | +/- 20 % | 0,035-0,047 | 336 002 413 |
| | | white | 230 V AC | +/- 20 % | 0,037-0,055 | 336 004 413 |
| | | blue | 230 V AC | +/- 20 % | 37-55 | 336 005 413 |
| | | green | 230 V AC | +/- 20 % | 0,037-0,055 | 336 006 413 |
| | | yellow | 230 V AC | +/- 20 % | 0,035-0,047 | 336 007 413 |
| mDD2 | clear | red | 24 V DC | +/- 20 % | 0,24-0,85 | 336 002 005 |
| | | white | 24 V DC | +/- 20 % | 0,32-1,28 | 336 004 005 |
| | | blue | 24 V DC | +/- 20 % | 0,31-1,25 | 336 005 005 |
| | | green | 24 V DC | +/- 20 % | 0,31-1,2 | 336 006 005 |
| | | yellow | 24 V DC | +/- 20 % | 0,24-0,9 | 336 007 005 |



MPL

ACCESSORIES

| Type | Type of accessory | Order number |
|------|---|--------------|
| MPL | Mounting plate including explosion-proof junction box | 335 500 000 |